

- LEGEND**
- CONCRETE MONUMENT FOUND
  - 1/2" STEEL PIN FOUND (UNLESS NOTED)
  - 1/2" STEEL PIN SET W/CAP STAMPED 'LENZ & ASSOC.'
  - ⊙ PIPE FOUND
  - ▲ NAIL FOUND
  - ≡ WOOD FENCE
  - ⊘ WIRE FENCE
  - ⊗ CHAIN LINK FENCE
  - P.U.E. PUBLIC UTILITY EASEMENT
  - D.E. DRAINAGE EASEMENT
  - B.L. BUILDING LINE
  - ⊙ POWER POLE
  - OU- OVERHEAD UTILITY LINE
  - DOWN GUY
  - (BRG.~DIST.) RECORD CALL

THIS SURVEY WAS PREPARED WITHOUT THE BENEFIT OF A CURRENT TITLE COMMITMENT. THIS TRACT MAY BE SUBJECT TO EASEMENTS, CONDITIONS, OR RESTRICTIONS OF RECORD NOT SHOWN OR NOTED HEREON.

*Z A Lenz* 12-31-01  
DATE

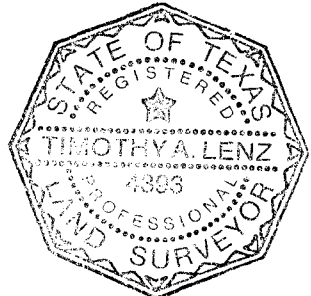

**LENZ & ASSOCIATES, INC.**

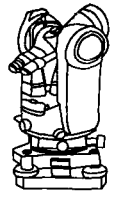

COMPLETE PROFESSIONAL LAND SURVEYING SERVICES  
 512/443-1174  
 1714 FORT VIEW ROAD, SUITE 101  
 AUSTIN, TEXAS 78704  
 SURVEY NO. : 2000-0760A F.B.# : 591/62

**REFERENCE:**

ADDRESS: 2503 EDgewater DRIVE  
 LEGAL DESC.: LOT 1, BLOCK A, RANCHERO DE LA, BOOK 94, PAGE 163, OF THE PLAT RECORDS OF TRAVIS COUNTY, TEXAS